

Jellyfin Family

WHMCS module

This module enables your company to offer public media services to customers through Jellyfin accounts. It facilitates the creation of customer accounts on a pre-configured Jellyfin server, allowing for the sale of various media packages at different prices. Moreover, it includes the functionality to add multiple media accounts for a single service. This feature enables customers to manage multiple Jellyfin accounts under one subscription. The module requires a pre-installed Jellyfin server and uses the Jellyfin API for client account management. It also supports multiple languages. Administrators can suspend, terminate, or unsuspend users, change user passwords, and more, while clients can manage their devices and libraries.

- [Description](#)
- [Changelog](#)
- [Installation and configuration guide](#)
 - [WHMCS setup\(install/update\)](#)
 - [Setup guide: Jellyfin setup](#)
 - [Setup guide: WHMCS setup](#)
 - [Add server \(Jellyfin server\)](#)
 - [Product Configuration](#)
 - [Add new library/item in Jellyfin](#)
 - [Getting Access Hash \(API key\)](#)
- [Client Area](#)
 - [Home screen](#)
 - [Add Media Account](#)
 - [Management Media account](#)
- [Admin Area](#)

- Product Information

Description

Jellyfin Family module **WHMCS**

[Order now](#) | [Download](#) | [FAQ](#)

Thanks to the module, the company can now offer public media services to its customers based on Jellyfin accounts with added flexibility.

The module facilitates the creation of customer accounts on a pre-prepared Jellyfin server. Now, it empowers users to define and manage multiple media accounts, allowing for more tailored offerings and increased customer satisfaction. Each account corresponds to a selected package, enabling customers to access varied media content at different price points. Notably, clients can now possess multiple independent media accounts, broadening their media access options.

For the correct operation of the module, a pre-prepared Jellyfin installation is required (the module does not assist in the installation of the Jellyfin server and assumes that such installation is ready for operation through API.) Module use Jellyfin API to manage clients account.

We have prepared a detailed installation manual for the module, including all the steps needed to implement the module, including the preparation of the Jellyfin server, including all installation steps such as PHP, Jellyfin, SSL certificates etc.

Functions:

- Auto create and deploy client account
- Multi-Account Support: Enable users to manage multiple media accounts within a single service
- The module uses only the API to manage the accounts
- Module supports multilingualism (**Arabic, Azerbaijani, Catalan, Chinese, Croatian, Czech, Danish, Dutch, English, Estonian, Farsi, French, German, Hebrew, Hungarian, Italian, Macedonian, Norwegian, Polish, Romanian, Spanish, Swedish, Turkish, Ukrainian**)
- The module shows all user info: enabled user libraries, active devices etc.
- Link to instructions for setting up the service in the client area.

Available options in the admin panel:

- Create users
- Suspend users
- Terminate users
- Unsuspend users
- Change users password
- Change Package
- Drop all devices
- Unblock user
- API connection status
- List of active devices
- List of enabled user libraries
- List of Media Accounts

Available options in the client panel:

- List of active devices
- List of enabled user libraries
- Drop all devices
- Unblock user
- Change the Jellyfin user password
- Add/Management/Delete Media Account
- Drop Account Devices
- List of Media Accounts

- ★ Overview ^
- i Information
- + Add Media Account
- 🔧 Actions ^
- 🔑 Change Password
- ⚙️ Drop All Devices
- ⚙️ Unblock
- 🕒 Request Cancellation



Jellyfin Family
PUQ Jellyfin Family

ACTIVE

🕒 Request Cancellation

Registration Date
Friday, July 12th, 2024

Recurring Amount
2.00 EUR

Billing Cycle
Monthly

Next Due Date
Monday, August 12th, 2024

Payment Method
PayPal

Manage

User manual

Web interface

Username: 7-5225

Password:

Status: Enable

Libraries: Clips Movies

Failed Login Attempt: 0/3

Active Devices: 1

Device Name	App Name	Last Activity
Chrome	Jellyfin Web	2024-07-12T08:17:39.6635919Z

Streaming bitrate limit: 12 Mbps

Sync Play Access: Allow to create and join groups

Count of Media Account: 1/11

+ Add Media Account



7-5225-test

Account Management

Jellyfin Family

Go

+ New Addon

More

Order #790 - View Order

Product/ServiceJellyfin Family

ServerPUQ Jellyfin Family (3/200 Accounts)

Domain

Dedicated IP

Username7-5157

Password

StatusActive

Registration Date2024/04/26

Quantity1

First Payment Amount2.00

Recurring Amount2.00
Recalculate on Save
☐ No

Next Due Date2024/05/26

Termination Date

Billing CycleMonthly

Payment MethodPayPal

Promotion CodeNone

Module Commands

CreateSuspendUnsuspendTerminateChange PackageChange PasswordDrop All DevicesUnblock

API Connection status

API answer OK

User

Username: 7-5157 Is Disabled : NO

Libraries

Beginner's Programming CourseClipsMovies

Info

Streaming bitrate limit	Count of Media Account	Active Sessions	Failed Login Attempt	Sync Play Access
0 Mbps	1/20	1/4	0/3	Allow user to create and join groups

Active User Devices

Device Name	App Name	Last Activity
Chrome	Jellyfin Web	2024-05-06T10:07:37.5569311Z

Media Accounts

Enabled	Username	Enabled Libraries
<input checked="" type="checkbox"/>	7-5157-test	Beginner's Programming CourseMovies

Changelog

Jellyfin Family module **WHMCS**

[Order now](#) | [Download](#) | [FAQ](#)

v1.3.2 Released 13-08-2024

1. Fixed bug with password, when "Show password" is "no"
 2. Fixed a bug with sub-accounts. Now, if the number of media accounts equals 0, when "Change package" is clicked, the sub-accounts are removed.
-

v1.3.1 Released 31-07-2024

1. Fixed a bug with adding sub-accounts when the allowed count of media sub-accounts is 0
-

v1.3 Released 31-07-2024

1. Fixed bug with header template
 2. Fixed bug with updating sub-account password in database
-

v1.2 Released 12-07-2024

1. Client area more adapted for mobile version
 2. Buttons for copying login and password have been added to the client area
 3. Fixed bug with edit sub-account
-

v1.1 Released 15-05-2024

1. Fixed a bug where purchasing a new service would alter the parameters of all accounts on the server.
2. Translate some phrases

3. Some changes in client area

v1.0 Released 02-05-2024

First version

Installation and configuration guide

WHMCS

setup(install/update)

Jellyfin Family module **WHMCS**

[Order now](#) | [Download](#) | [FAQ](#)

To install and update a module, you must perform one and the same action.

1. Download the latest version of the module.

PHP 8.1

```
wget http://download.puqcloud.com/WHMCS/servers/PUQ_WHMCS-Jellyfin-Family/PUQ_WHMCS-Jellyfin-Family-latest.zip
```

PHP 7.4

```
wget https://download.puqcloud.com/WHMCS/servers/PUQ_WHMCS-Jellyfin-Family/php74/PUQ_WHMCS-Jellyfin-Family-latest.zip
```

All versions are available via link:

http://download.puqcloud.com/WHMCS/servers/PUQ_WHMCS-Jellyfin-Family/

2. Unzip the archive with the module.

```
unzip PUQ_WHMCS-Jellyfin-Family-latest.zip
```

3. Copy and Replace "puqJellyfinFamily" to
"WHMCS_WEB_DIR/modules/servers/"

Setup guide: Jellyfin setup

Jellyfin Family module **WHMCS**

[Order now](#) | [Download](#) | [FAQ](#)

1. Install Jellyfin on your server

To simplify deployment and help automate this for as many users as possible, we provide a BASH script to handle repo installation as well as installing Jellyfin. All you need to do is run this command on your system

```
wget -O- https://repo.jellyfin.org/install-debuntu.sh | sudo bash
```

2. SSL certificate generation:

```
sudo apt install nginx certbot python3-certbot-nginx
```

```
sudo certbot --nginx --agree-tos --redirect --hsts --staple-ocsp --email YOUR_EMAIL -d  
DOMAIN_NAME
```

```
echo "0 0 * * * root certbot renew --quiet --no-self-upgrade --post-hook 'systemctl reload  
nginx'" | sudo tee -a /etc/cron.d/renew_certbot
```

3. Configure nginx from a subdomain

Create a file named jellyfin.conf.

```
cd /etc/nginx/conf.d/  
nano jellyfin.conf
```

Then, insert the following text, replacing **DOMAIN_NAME** with your domain.

```
# Uncomment the commented sections after you have acquired a SSL Certificate
server {
    listen 80;
    listen [::]:80;
    server_name DOMAIN_NAME;

    # Uncomment to redirect HTTP to HTTPS
    return 301 https://$host$request_uri;
}

server {
    listen 443 ssl http2;
    listen [::]:443 ssl http2;
    server_name DOMAIN_NAME;

    ## The default `client_max_body_size` is 1M, this might not be enough for some posters, etc.
    client_max_body_size 20M;

    # use a variable to store the upstream proxy
    # in this example we are using a hostname which is resolved via DNS
    # (if you aren't using DNS remove the resolver line and change the variable to point to an IP
    address e.g `set $jellyfin 127.0.0.1`)
    set $jellyfin 127.0.0.1;
    resolver 127.0.0.1 valid=30;

    ssl_certificate /etc/letsencrypt/live/DOMAIN_NAME/fullchain.pem;
    ssl_certificate_key /etc/letsencrypt/live/DOMAIN_NAME/privkey.pem;
    include /etc/letsencrypt/options-ssl-nginx.conf;
    ssl_dhparam /etc/letsencrypt/ssl-dhparams.pem;
    add_header Strict-Transport-Security "max-age=31536000" always;
    ssl_trusted_certificate /etc/letsencrypt/live/DOMAIN_NAME/chain.pem;
    ssl_stapling on;
    ssl_stapling_verify on;

    # Security / XSS Mitigation Headers
    # NOTE: X-Frame-Options may cause issues with the webOS app
    add_header X-Frame-Options "SAMEORIGIN";
    add_header X-XSS-Protection "0"; # Do NOT enable. This is obsolete/dangerous
```

```

add_header X-Content-Type-Options "nosniff";

# COOP/COEP. Disable if you use external plugins/images/assets
add_header Cross-Origin-Opener-Policy "same-origin" always;
add_header Cross-Origin-Embedder-Policy "require-corp" always;
add_header Cross-Origin-Resource-Policy "same-origin" always;

# Permissions policy. May cause issues on some clients
add_header Permissions-Policy "accelerometer=(), ambient-light-sensor=(), battery=(),
bluetooth=(), camera=(), clipboard-read=(), display-capture=(), document-domain=(), encrypted-
media=(), gamepad=(), geolocation=(), gyroscope=(), hid=(), idle-detection=(), interest-
cohort=(), keyboard-map=(), local-fonts=(), magnetometer=(), microphone=(), payment=(),
publickey-credentials-get=(), serial=(), sync-xhr=(), usb=(), xr-spatial-tracking=()" always;

# Tell browsers to use per-origin process isolation
add_header Origin-Agent-Cluster "?1" always;

# Content Security Policy
# See: https://developer.mozilla.org/en-US/docs/Web/HTTP/CSP
# Enforces https content and restricts JS/CSS to origin
# External Javascript (such as cast_sender.js for Chromecast) must be whitelisted.
# NOTE: The default CSP headers may cause issues with the webOS app
#add_header Content-Security-Policy "default-src https: data: blob: http://image.tmdb.org;
style-src 'self' 'unsafe-inline'; script-src 'self' 'unsafe-inline' https://www.gstatic.com
https://www.youtube.com blob:; worker-src 'self' blob:; connect-src 'self'; object-src
'none'; frame-ancestors 'self'";

location = / {
    return 302 http://$host/web/;
    #return 302 https://$host/web/;
}

location / {
    # Proxy main Jellyfin traffic
    proxy_pass http://$jellyfin:8096;
    proxy_set_header Host $host;
    proxy_set_header X-Real-IP $remote_addr;
    proxy_set_header X-Forwarded-For $proxy_add_x_forwarded_for;
    proxy_set_header X-Forwarded-Proto $scheme;

```



```

    proxy_set_header X-Forwarded-Protocol $scheme;
    proxy_set_header X-Forwarded-Host $http_host;

    # Disable buffering when the nginx proxy gets very resource heavy upon streaming
    proxy_buffering off;
}

# location block for /web - This is purely for aesthetics so /web/# / works instead of having
to go to /web/index.html/# /
location = /web/ {
    # Proxy main Jellyfin traffic
    proxy_pass http://$jellyfin:8096/web/index.html;
    proxy_set_header Host $host;
    proxy_set_header X-Real-IP $remote_addr;
    proxy_set_header X-Forwarded-For $proxy_add_x_forwarded_for;
    proxy_set_header X-Forwarded-Proto $scheme;
    proxy_set_header X-Forwarded-Protocol $scheme;
    proxy_set_header X-Forwarded-Host $http_host;
}

location /socket {
    # Proxy Jellyfin Websockets traffic
    proxy_pass http://$jellyfin:8096;
    proxy_http_version 1.1;
    proxy_set_header Upgrade $http_upgrade;
    proxy_set_header Connection "upgrade";
    proxy_set_header Host $host;
    proxy_set_header X-Real-IP $remote_addr;
    proxy_set_header X-Forwarded-For $proxy_add_x_forwarded_for;
    proxy_set_header X-Forwarded-Proto $scheme;
    proxy_set_header X-Forwarded-Protocol $scheme;
    proxy_set_header X-Forwarded-Host $http_host;
}
}

```

Restarting nginx

```
sudo service nginx restart
```

Setup guide: WHMCS setup

Jellyfin Family module **WHMCS**

[Order now](#) | [Download](#) | [FAQ](#)

1. Download the latest version of the module.

PHP 8.1

```
wget https://download.puqcloud.com/WHMCS/servers/PUQ_WHMCS-Jellyfin-Family/PUQ_WHMCS-Jellyfin-Family-latest.zip
```

PHP 7.4

```
wget https://download.puqcloud.com/WHMCS/servers/PUQ_WHMCS-Jellyfin-Family/php74/PUQ_WHMCS-Jellyfin-Family-latest.zip
```

All versions are available via link:

http://download.puqcloud.com/WHMCS/servers/PUQ_WHMCS-Jellyfin-Family/

2. Unzip the archive with the module.

```
unzip PUQ_WHMCS-Jellyfin-Family-latest.zip
```

3. Copy "puqJellyfinFamily" to "WHMCS_WEB_DIR/modules/servers/"

4. Create new server Jellyfin in WHMCS (System Settings->Products/Services->Servers)

System Settings->Servers->Add New Server

- Enter the correct **Name** and **Hostname**

Name	<input type="text" value="jellyfin [REDACTED]"/>
Hostname	<input type="text" value="jellyfin [REDACTED]"/>
IP Address	<input type="text"/>
Assigned IP Addresses (One per line)	<div></div>
Monthly Cost	<input type="text"/>
Datacenter/NOC	<input type="text"/>
Maximum No. of Accounts	<input type="text" value="200"/>
Server Status Address	<div></div> <p>To display this server on the server status page, enter the full path to the folder (required to be uploaded to each server you want to monitor) - e.g. https://www.example.com/status/</p>
Enable/Disable	<input type="checkbox"/> Check to disable this server

- In the **Server Details** section, select the "**PUQ Jellyfin Family**" module and enter the correct **username**, **password** and **access hash (API key)** for the **Jellyfin web interface**.
- To check, click the "**Test connection**" button

Module	<div>PUQ Jellyfin Family</div> <div>Test Connection</div> <div>✓ Connection successful. Some values have been auto-filled.</div>
Username	<div>admin</div>
Password	<div>.....</div>
Access Hash	<div>5</div>
Secure	<div><input checked="" type="checkbox"/> Check to use SSL Mode for Connections</div>
Port	<div><div>443</div><div><input type="checkbox"/> Override with Custom Port</div></div>

5. Create a new Products/Services

System Settings->Products/Services->Create a New Product

In the **Module settings** section, select the **"PUQ Jellyfin Family"** module

Module Name

PUQ Jellyfin Family

Server Group

PUQ Jellyfin Family

License key

2CLDQ2[REDACTED]-RKSRB1

success: 2024-05-11T16:04:28+02:00

Media Accounts Configuration

Count of media accounts:

20

Available number of media accounts for creation by user

Streaming bitrate limit:

Mbps

SyncPlay access:

Allow user to create and join groups

Sync playback with other devices

Remote control:

☐ Remote control of shared devices (DLNA devices are considered shared until a user begins controlling them)

☐ Users can download media and store it on their devices. This is not the same as a sync feature. Book libraries require this enabled to function properly.

Media downloads:

User sessions:

4

A value of 0 will disable the feature.

Failed login attempts:

before user is locked out. Setting this to -1 will disable the feature.

Username prefix:

Will be attached to the beginning of username.
Only small letters and numbers and symbol "-"

Username suffix:

Will be appended to the end of username.
Only small letters and numbers and symbol "-"

Allow Live TV access:

☐

Allow Live TV recording management:

☐

Force transcoding of remote media sources such as Live TV:

☐

Show Password:

Show button

Show service password in the client area

Libraries Configuration

Use All Libraries:

☒ select all libraries together

Libraries:

Write down the libraries you want to make available to customers of this product.
(IMPORTANT! Start a new line for each new library)
Example:
"Movies
Beginner's Programming Course
Comedy"

IMPORTANT!

If you have a folder named "-", please enter it not as the first one or rename it.
If you don't want any folder to be accessible, type "-".

User Configuration

media:

☐

audio that requires transcoding:

☐

video that requires transcoding:

☐

video that requires conversion without re-encoding:

☐

Links

Instruction:

A link to the instruction will be reflected in the client area.

Feature access

Client Area

Switch to Advanced Mode

☐ Automatically setup the product as soon as an order is placed

☒ Automatically setup the product as soon as the first payment is received

☐ Automatically setup the product when you manually accept a pending order

☐ Do not automatically setup this product

• **License key:** A pre-purchased license key for the "PUQ Jellyfin Family" module. For the module to work correctly, the key must be active

Media Accounts Configuration

- **Count of media accounts:** Available number of media accounts for creation by user.

Libraries:

- **Use All Libraries:** Choosing all of libraries from your Jellyfin server
- **Libraries:** The libraries you want to make available to customers of this product.

(IMPORTANT! Start a new line for each new library)

Example:

"Movies

Beginner`s Programming Course

Comedy"

IMPORTANT!

If you have a folder named "-", please enter it not as the first one or rename it.

If you don't want any folder to be accessible, type "-".

User Configuration:

- **Streaming bitrate limit:** An optional per-stream bitrate limit for all out of network devices. This is useful to prevent devices from requesting a higher bitrate than your internet connection can handle. This may result in increased CPU load on your server in order to transcode videos on the fly to a lower bitrate.
- **SyncPlay access:** The SyncPlay feature enables to sync playback with other devices. Select the level of access this user has to the SyncPlay
- **Remote control:** Remote control of shared devices (DLNA devices are considered shared until a user begins controlling them)
- **Media downloads:** Users can download media and store it on their devices. This is not the same as a sync feature. Book libraries require this enabled to function properly.
- **User sessions:** Set the maximum number of simultaneous user sessions.
A value of 0 will disable the feature.
- **Failed login attempts:** Determine how many incorrect login tries can be made before lockout occurs.
A value of zero means inheriting the default of three tries for normal users and five for administrators. Setting this to -1 will disable the feature.
- **Username prefix/Username suffix:** Necessary in order to generate a username for the service, in the format: **prefix<client_id>-<service_id>suffix**

Allow playback (Restricting access to transcoding may cause playback failures in clients due to unsupported media formats)

- **media**
- **audio that requires transcoding**
- **video that requires transcoding**
- **video that requires conversion without re-encoding**

Feature access:

- **Allow Live TV access**
- **Allow Live TV recording management**
- **Force transcoding of remote media sources such as Live TV**

Links

- **Link to instruction:** Link to the instruction, if filled out, it will be reflected in the client area

Add server (Jellyfin server)

Jellyfin Family module **WHMCS**

[Order now](#) | [Download](#) | [FAQ](#)

Add a new server to the system WHMCS.

System Settings->Servers->Add New Server

- Enter the correct **Name** and **Hostname**

Name	<input type="text" value="jellyfin [REDACTED]"/>
Hostname	<input type="text" value="jellyfin [REDACTED]"/>
IP Address	<input type="text"/>
Assigned IP Addresses (One per line)	<div></div>
Monthly Cost	<input type="text"/>
Datacenter/NOC	<input type="text"/>
Maximum No. of Accounts	<input type="text" value="200"/>
Server Status Address	<div></div> <p>To display this server on the server status page, enter the full path to the folder (required to be uploaded to each server you want to monitor) - e.g. https://www.example.com/status/</p>
Enable/Disable	<input type="checkbox"/> Check to disable this server

- In the **Server Details** section, select the "**PUQ Jellyfin Family**" module and enter the correct **username**, **password** and **access hash (API key)** for the **Jellyfin web interface**.
- To check, click the "**Test connection**" button

Module	<div>PUQ Jellyfin Family</div> <div>Test Connection</div> <div>✓ Connection successful. Some values have been auto-filled.</div>
Username	<div>admin</div>
Password	<div>.....</div>
Access Hash	<div>5 [REDACTED]</div>
Secure	<div><input checked="" type="checkbox"/> Check to use SSL Mode for Connections</div>
Port	<div><div>443</div><div><input type="checkbox"/> Override with Custom Port</div></div>

Product Configuration

Jellyfin Family module **WHMCS**

[Order now](#) | [Download](#) | [FAQ](#)

Create a new Products/Services

System Settings->Products/Services->Create a New Product

In the **Module settings** section, select the "**PUQ Jellyfin Family**" module

Module Name

PUQ Jellyfin Family

Server Group

PUQ Jellyfin Family

License key

2CLDQ2-RKSRB1

success: 2024-05-11T16:04:28+02:00

Libraries Configuration

Use All Libraries: ☒ select all libraries together

Write down the libraries you want to make available to customers of this product.
(IMPORTANT! Start a new line for each new library)
Example:
"Movies
Beginner's Programming Course
Comedy"

IMPORTANT!

If you have a folder named "-", please enter it not as the first one or rename it.
If you don't want any folder to be accessible, type "-".

Allow playback

media: ☐

audio that requires transcoding: ☐

video that requires transcoding: ☐

video that requires conversion without re-encoding: ☐

Links

Instruction:

A link to the instruction will be reflected in the client area.

Media Accounts Configuration

Count of media accounts:

20

Available number of media accounts for creation by user

Streaming bitrate limit:

Mbps

SyncPlay access:

Allow user to create and join gro

Sync playback with other devices

Remote control:

☐ Remote control of shared devices (DLNA devices are considered shared until a user begins controlling them)

☐ Users can download media and store it on their devices. This is not the same as a sync feature. Book libraries require this enabled to function properly.

Media downloads:

User sessions:

4

A value of 0 will disable the feature.

Failed login attempts:

before user is locked out. Setting this to -1 will disable the feature.

Username prefix:

Will be attached to the beginning of username.
Only small letters and numbers and symbol "-"

Username suffix:

Will be appended to the end of username.
Only small letters and numbers and symbol "-"

Feature access

Allow Live TV access: ☐

Allow Live TV recording management: ☐

Force transcoding of remote media sources such as Live TV: ☐

Client Area

Show Password:

Show button

Show service password in the client area

☐ Automatically setup the product as soon as an order is placed

☒ Automatically setup the product as soon as the first payment is received

☐ Automatically setup the product when you manually accept a pending order

☐ Do not automatically setup this product

[Switch to Advanced Mode](#)

- **License key:** A pre-purchased license key for the "PUQ Jellyfin Family" module. For the module to work correctly, the key must be active

Media Accounts Configuration

- **Count of media accounts:** Available number of media accounts for creation by user.

Libraries:

- **Use All Libraries:** Choosing all of libraries from your Jellyfin server
- **Libraries:** The libraries you want to make available to customers of this product.

(IMPORTANT! Start a new line for each new library)

Example:

"Movies

Beginner`s Programming Course

Comedy"

IMPORTANT!

If you have a folder named "-", please enter it not as the first one or rename it.

If you don't want any folder to be accessible, type "-".

User Configuration:

- **Streaming bitrate limit:** An optional per-stream bitrate limit for all out of network devices. This is useful to prevent devices from requesting a higher bitrate than your internet connection can handle. This may result in increased CPU load on your server in order to transcode videos on the fly to a lower bitrate.
- **SyncPlay access:** The SyncPlay feature enables to sync playback with other devices. Select the level of access this user has to the SyncPlay
- **Remote control:** Remote control of shared devices (DLNA devices are considered shared until a user begins controlling them)
- **Media downloads:** Users can download media and store it on their devices. This is not the same as a sync feature. Book libraries require this enabled to function properly.
- **User sessions:** Set the maximum number of simultaneous user sessions.
A value of 0 will disable the feature.
- **Failed login attempts:** Determine how many incorrect login tries can be made before lockout occurs.
A value of zero means inheriting the default of three tries for normal users and five for administrators. Setting this to -1 will disable the feature.
- **Username prefix/Username suffix:** Necessary in order to generate a username for the service, in the format: **prefix<client_id>-<service_id>suffix**

Allow playback (Restricting access to transcoding may cause playback failures in clients due to unsupported media formats)

- **media**
- **audio that requires transcoding**
- **video that requires transcoding**
- **video that requires conversion without re-encoding**

Feature access:

- **Allow Live TV access**
- **Allow Live TV recording management**
- **Force transcoding of remote media sources such as Live TV**

Links

- **Link to instruction:** Link to the instruction, if filled out, it will be reflected in the client area

Add new library/item in Jellyfin

Jellyfin Family module **WHMCS**

[Order now](#) | [Download](#) | [FAQ](#)

New library:

To create a new library, you should to **create a folder** in your jellyfin server.

First, navigate to the root of your project "/" and enter the following commands:

```
cd mnt
```

```
mkdir LIBRARY_NAME
```

LIBRARY_NAME - The name of the new library.

After creating a folder, let's create a library in Jellyfin:

Add a new library:

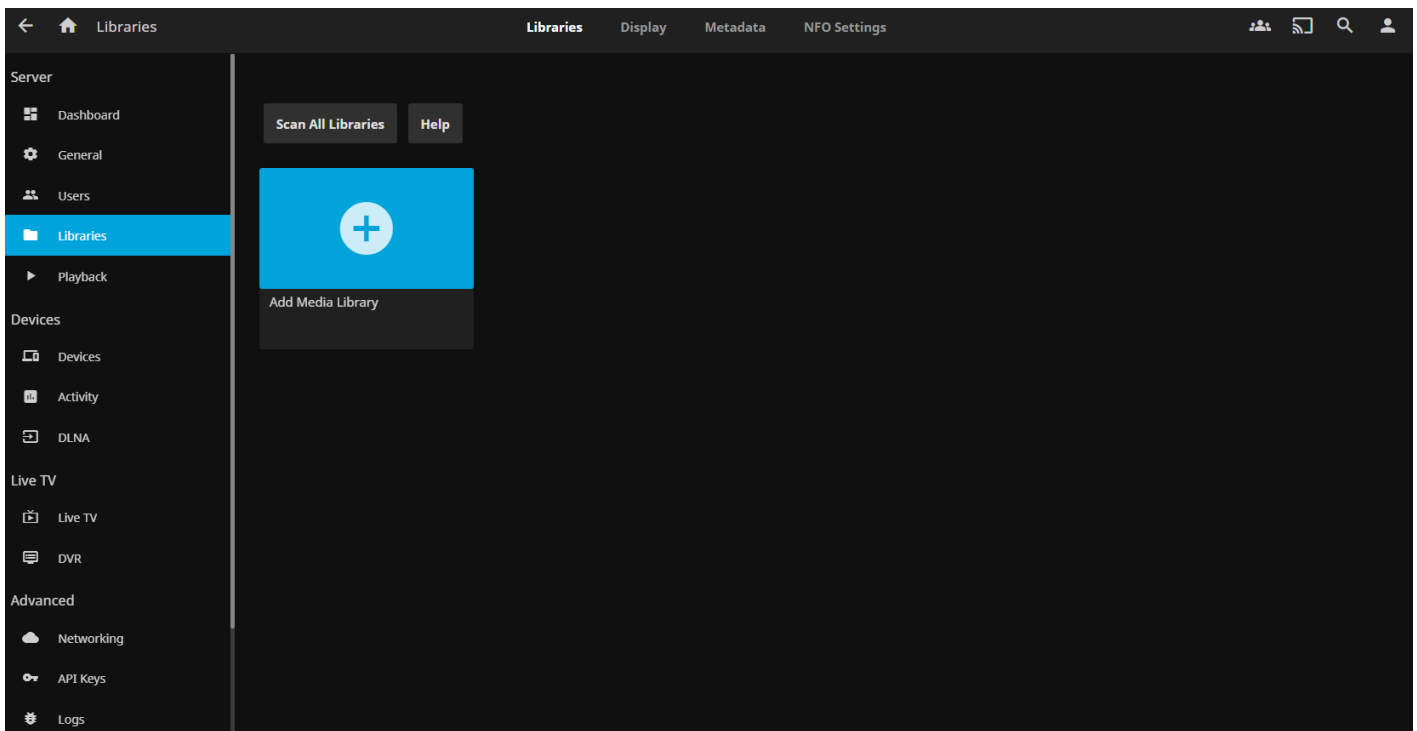

Assign the appropriate folder to this library:

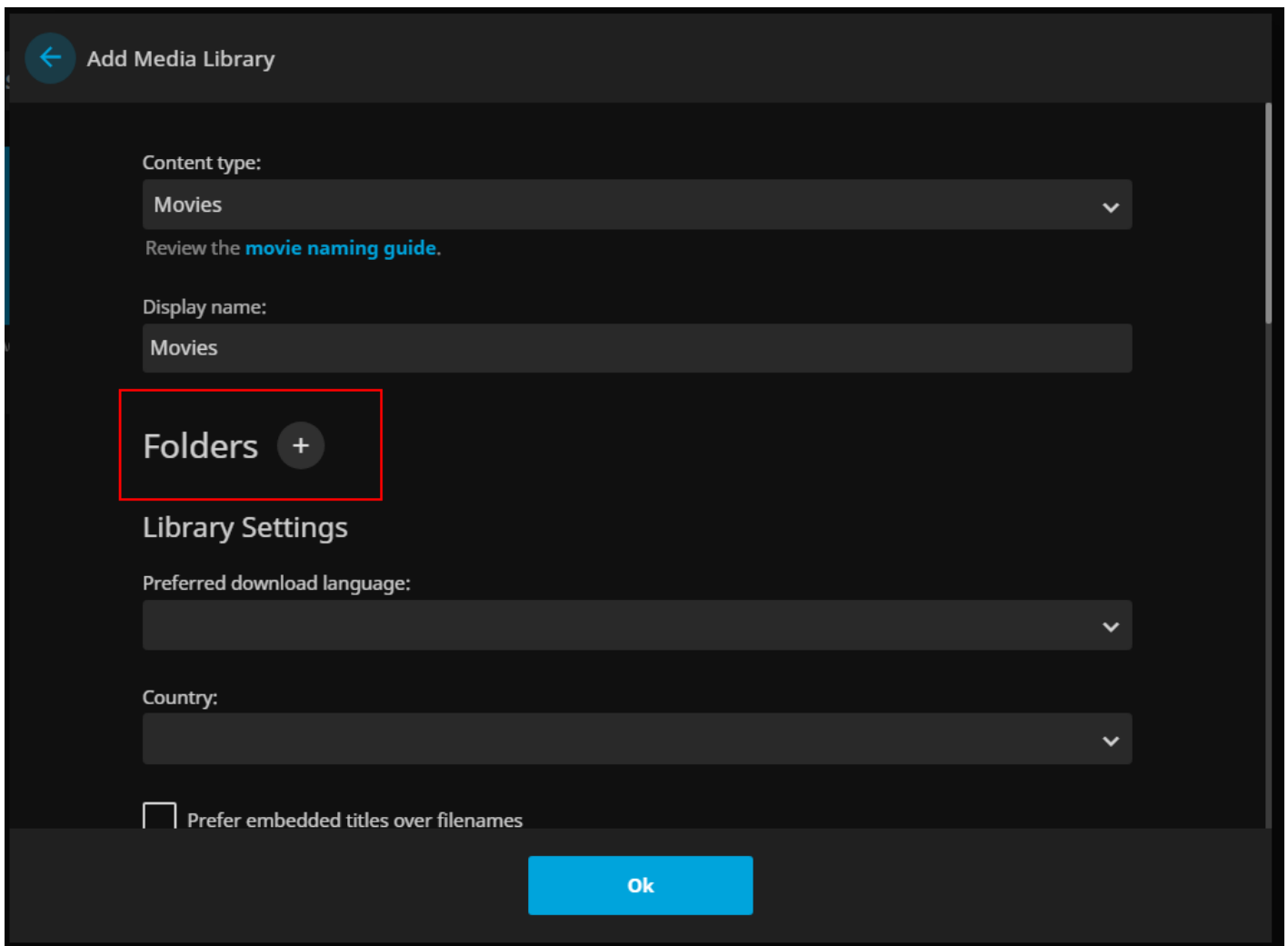

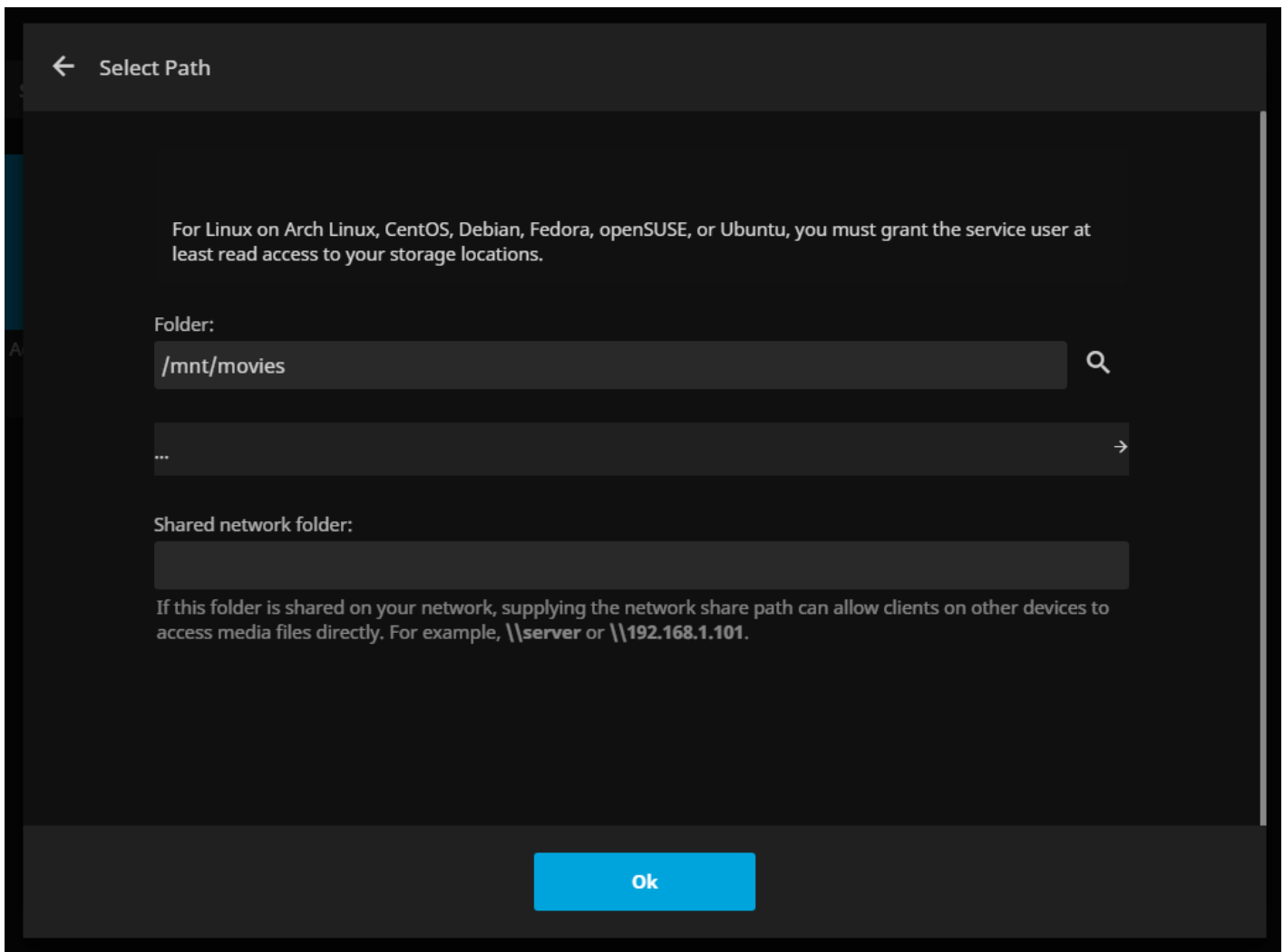

New item:

To download a new item, navigate to the root of your project "/" and enter the following commands:

```
cd mnt/LIBRARY_NAME
```

```
wget DOWNLOAD_ITEM_URL
```

LIBRARY_NAME - The name of the library.

DOWNLOAD_ITEM_URL - The download URL of the item you want to upload to the server.

After all

Scan all libraries by clicking on the "Scan All Libraries" button. To scan a specific library, click on the three dots and select "Scan Library".

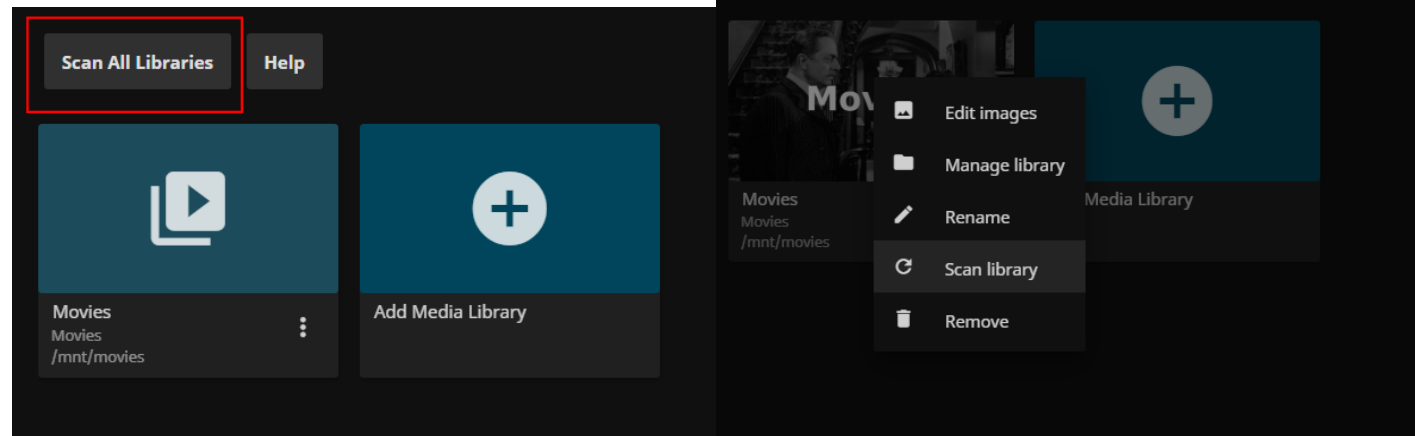

Getting Access Hash (API key)

Jellyfin Family module **WHMCS**

[Order now](#) | [Download](#) | [FAQ](#)

Dashboard -> API Keys

Create a new API Key

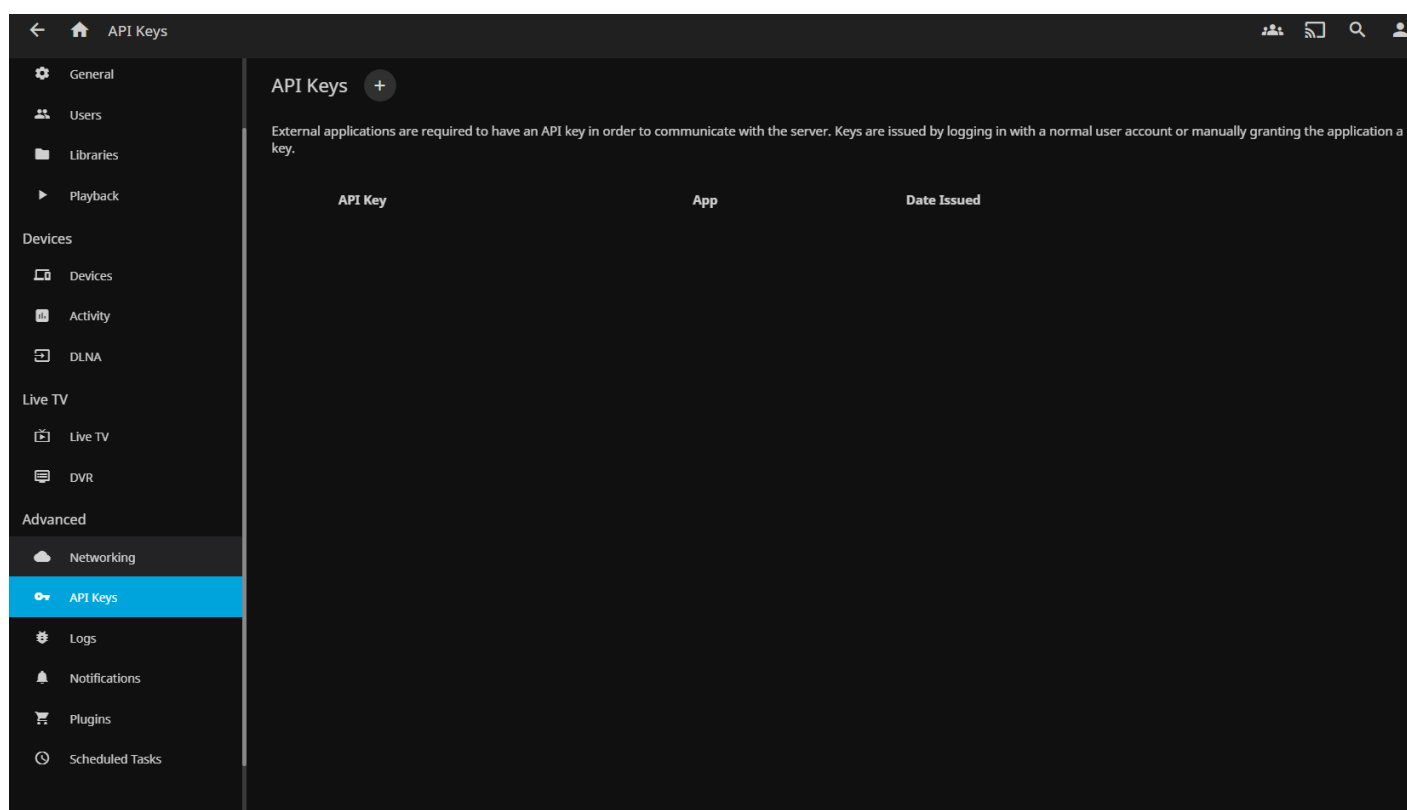

Whrite an App Name

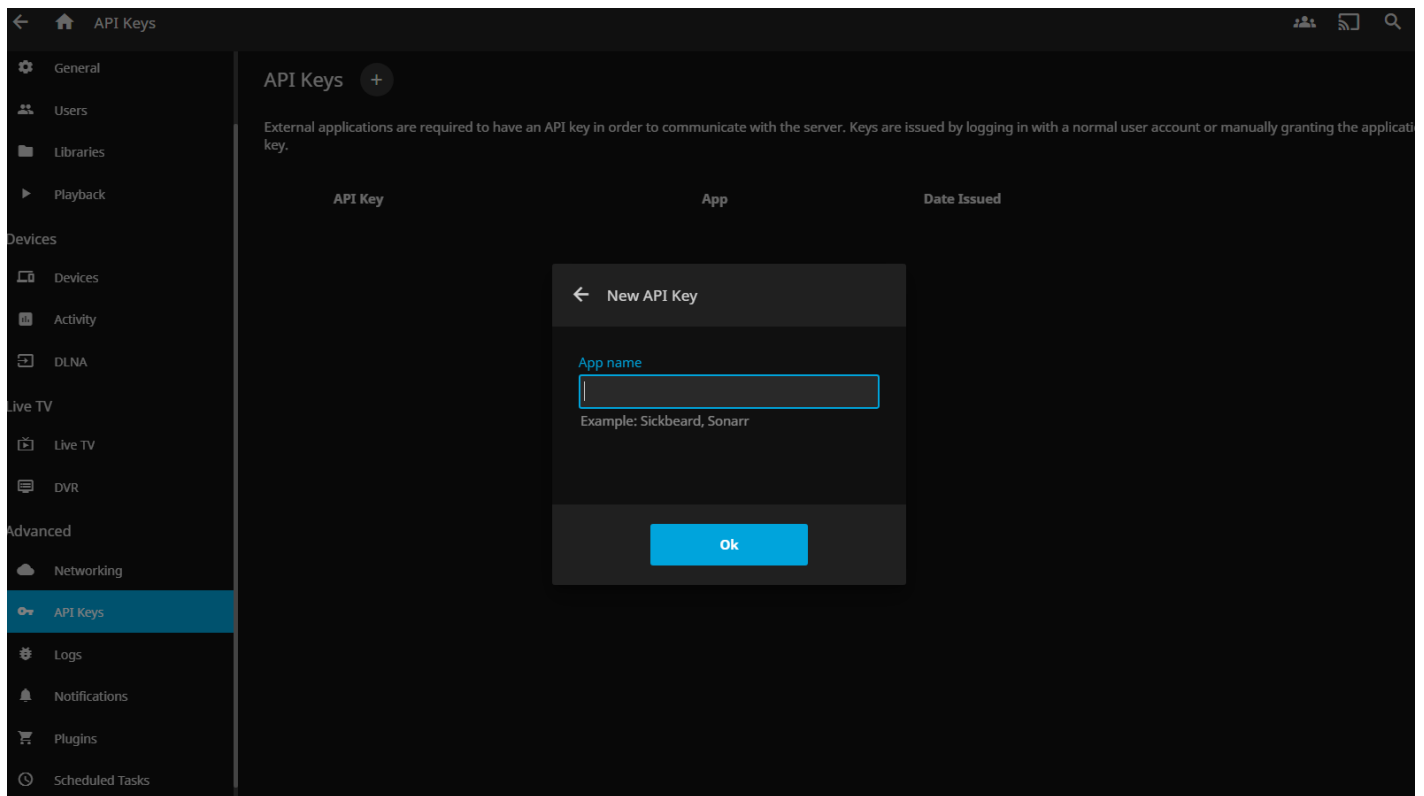

Now you can getting an API key

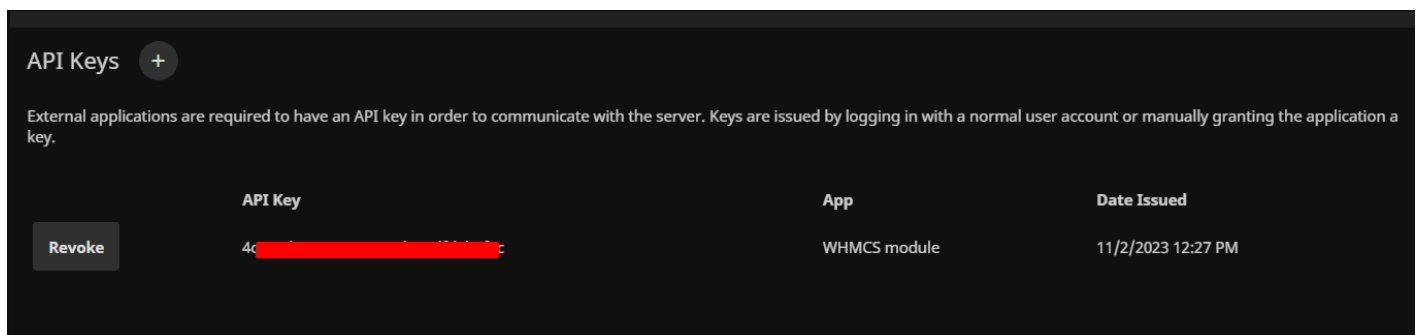

Client Area

Home screen

Jellyfin Family module **WHMCS**

[Order now](#) | [Download](#) | [FAQ](#)

The end customer, after logging in to his own customer panel, has access to the following information and options

- Link to the user manual (which was defined by the administrator when setting up the service.).
- Jellyfin server address
- Authorization data
- User informations
- List of active devices
- List of enabled user libraries
- Drop all devices
- Unblock user
- Change the Jellyfin user password
- Add/Management/Delete Media Account
- Drop Account Devices
- List of Media Accounts

★ Overview ^

i Information

+ Add Media Account

⚙ Actions ^

🔑 Change Password

⚙ Drop All Devices

⚙ Unblock

🔄 Request Cancellation



Jellyfin Family
PUQ Jellyfin Family

ACTIVE

🔄 Request Cancellation

Registration Date
Friday, July 12th, 2024

Recurring Amount
2.00 EUR

Billing Cycle
Monthly

Next Due Date
Monday, August 12th, 2024

Payment Method
PayPal

🌐 Manage

User manual

Web interface

👤 Username: 7-5225

🔒 Password:

🛠 Status: Enable

📁 Libraries: Clips Movies

✖ Failed Login Attempt: 0/3

🛠 Active Devices: 1

Device Name	App Name	Last Activity
Chrome	Jellyfin Web	2024-07-12T08:17:39.6635919Z

🛠 Streaming bitrate limit: 12 Mbps

🔄 Sync Play Access: Allow to create and join groups

🛠 Count of Media Account: 1/11

+ Add Media Account

✓7-5225-testAccount Management

Add Media Account

Jellyfin Family module **WHMCS**

[Order now](#) | [Download](#) | [FAQ](#)

Username - Set a media account username. It consists of the username of the main account and a unique name for this media account.

Password - Write a password for registering the media account, or generate one by clicking Generate.

Disable libraries - Here are all the libraries available to the main account. If you want to restrict access for this media account to any of the libraries, simply select that library.

Press **Ctrl** to select multiple libraries.

Press **Shift** to select all libraries.

Management Media account

Jellyfin Family module **WHMCS**

[Order now](#) | [Download](#) | [FAQ](#)

Save ChangesDelete Media account

☒ Enabled:

Username:

7-5157-test

Password:

sdfsdfsdfsdf

Generate

Disable libraries:

Beginner`s Programming Course

Clips

Movies

Enabled - Update account status.

Username - Set a media account username. It consists of the username of the main account and a unique name for this media account.

Password - Write a password for registering the media account, or generate one by clicking Generate.

Disable libraries - Here are all the libraries available to the main account. If you want to restrict access for this media account to any of the libraries, simply select that library.

Press **Ctrl** to select multiple libraries.

Press **Shift** to select all libraries.

Media account active devices

Here is a list of active devices for this account.

Press "Drop Account Devices" to sign out from the devices.

Account Active Devices

Drop Account Devices

Device Name	App Name	Last Activity
Chrome	Jellyfin Web	2024-05-06T10:04:04.7989348Z

Admin Area

Product Information

Jellyfin Family module WHMCS

[Order now](#) | [Download](#) | [FAQ](#)

Here is the data presented for the service admin in WHMCS

Jellyfin Family

Go

+ New Addon

More

Order #	790 - View Order	Registration Date	2024/04/26
Product/Service	Jellyfin Family	Quantity	1
Server	PUQ Jellyfin Family (3/200 Accounts)	First Payment Amount	2.00
Domain		Recurring Amount	2.00 <small>Recalculate on Save</small> <input type="checkbox"/> No
Dedicated IP		Next Due Date	2024/05/26
Username	7-5157	Termination Date	
Password		Billing Cycle	Monthly
Status	Active	Payment Method	PayPal
		Promotion Code	None

Module Commands

CreateSuspendUnsuspendTerminateChange PackageChange PasswordDrop All DevicesUnblock

API Connection status

API answer OK

User

Username: 7-5157 Is Disabled : NO

Libraries

Beginner's Programming CourseClipsMovies

Streaming bitrate limit	Count of Media Account	Active Sessions	Failed Login Attempt	Sync Play Access
0 Mbps	1/20	1/4	0/3	Allow user to create and join groups

Active User Devices

Device Name	App Name	Last Activity
Chrome	Jellyfin Web	2024-05-06T10:07:37.5569311Z

Media Accounts

Enabled	Username	Enabled Libraries
✓	7-5157-test	Beginner's Programming CourseMovies